

Solar Air Heater

Dear customer,

Thank you for placing your trust in our product!

Before using the product for the first time, please make sure you read these operating instructions! Here you will find information about how to use the product safely and ensure its long service life. You should pay attention to all of the safety instructions in this document!

Technical Specification

Model number	TPS-H03A	TPS-H04
Heat absorber area	0.7m ²	1m ²
Solar output	18V, 6W	18V, 6W
DC fan specification	DC, 12V 180mA	DC, 12V 180mA
Heating area/per hour	100 m ³ /h	120 m ³ /h
Air outlet temperature	35°C~80°C	35°C~80°C
Adjustable air intake	Yes	Yes
Aluminum frame	Black coating	Black coating
Size	1006x664x85mm	1460x664x85mm
Weight	19KG	25KG

Feature

- This product is an air heating device which is powered by free sunlight only. No need of any conventional energy, and is independent from utility grid.
- Its heat source utilizes the high efficient blue sputter selective heat absorbing technology, turns sunlight into heat.
- Good for cottages, summer house, green houses, sheds, garages.
- Various modes with different heating capacity available.

How does it works

The product's built-in solar powered DC fan sucks in cool (or fresh) air from either one of the two air inlets. The cooler air is heated by the heat source while moving upward to the air outlet. Warm (or fresh) air will blow into the room through the PVC pipe. And the included thermostat allows you the stop the fan from blowing warm air into the house at your desire room temperature.

Function

- Air heating:** Serve as a hot air conditioner. Circulate and warm up air inside the room. To activate, please tighten the lid of the fresh air inlet, and loose the lid on diffuser 2 that connected to the cool air inlet. Air will be drawn into the air heating tunnel.
- Air exchanging:** Allow fresh air from outdoor to blow into the room. To activate, please tighten the lid on diffuser 2 that connected to the cool air inlet, and loose the lid on the fresh air inlet at bottom of the product. Air will be drawn into the fresh air tunnel.

How to install

1. Solar air heater can be mounted on outside of the wall or on top of the roof. Secure the product in a place where it can have the best exposure to sunlight. And there is no shadow will cast onto the product. So that product can work with max efficiency.
2. Drill a hole on the wall/roof to allow the pipe to pass through. Follow below steps:
 - Use the pipe to mark two circles on your desired position. The circles should be slightly bigger than the diameter of the pipe itself.
 - Drill two holes where the mark is made.
 - Measure the thickness of your wall, and cut the pipe to the length that matches the thickness. Please note that pipe #2 should be longer, because its flange is secured deeper into the product.
3. Secure both flanges onto the air inlet and outlet at back of the product with provided screws. Remember to put the silicon rubber sealer as per diagram in the following page.
4. Secure both pipes onto flange. Longer pipe is put into the deeper flange.
5. Secure lead wire coming out of the solar air heater alongside the pipe with tapes.
6. Secure product on the outside wall or roof in a way that the both pipes can pass through the holes.
7. Secure diffuser onto the pipe at the inside end of the wall/roof. Remember to pull the lead wire out.
8. Seal the gap between the wall hole and the pipe.
9. Secure the thermostat besides the diffuser, and connect the lead wire coming from solar air heater to thermostat. Connect the red wire to terminal 2, and the black wire (or blue wire) to terminal 3. Turn the knob to your desire temperature, the DC fan in the solar air heater will stop blowing hot air, when the room temperature is higher than the set temperature.

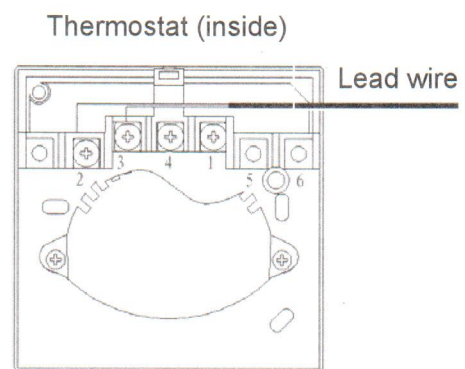
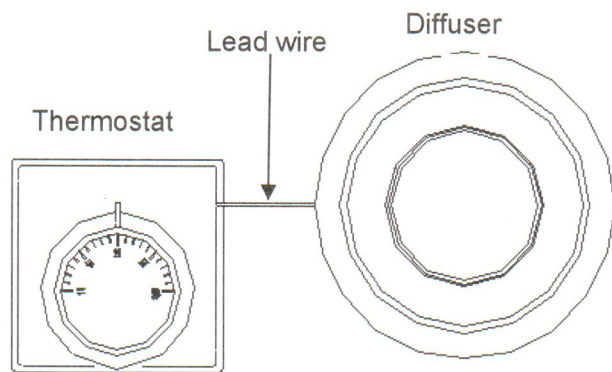
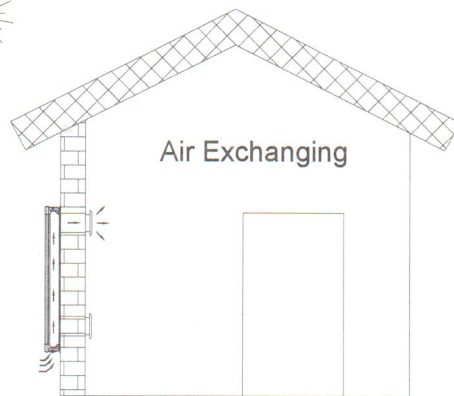
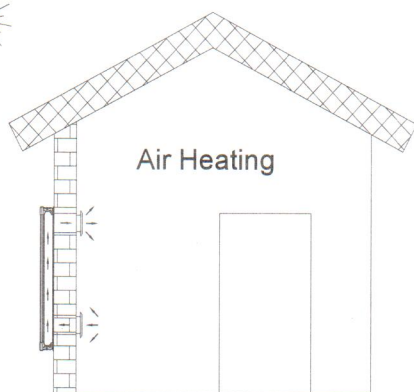
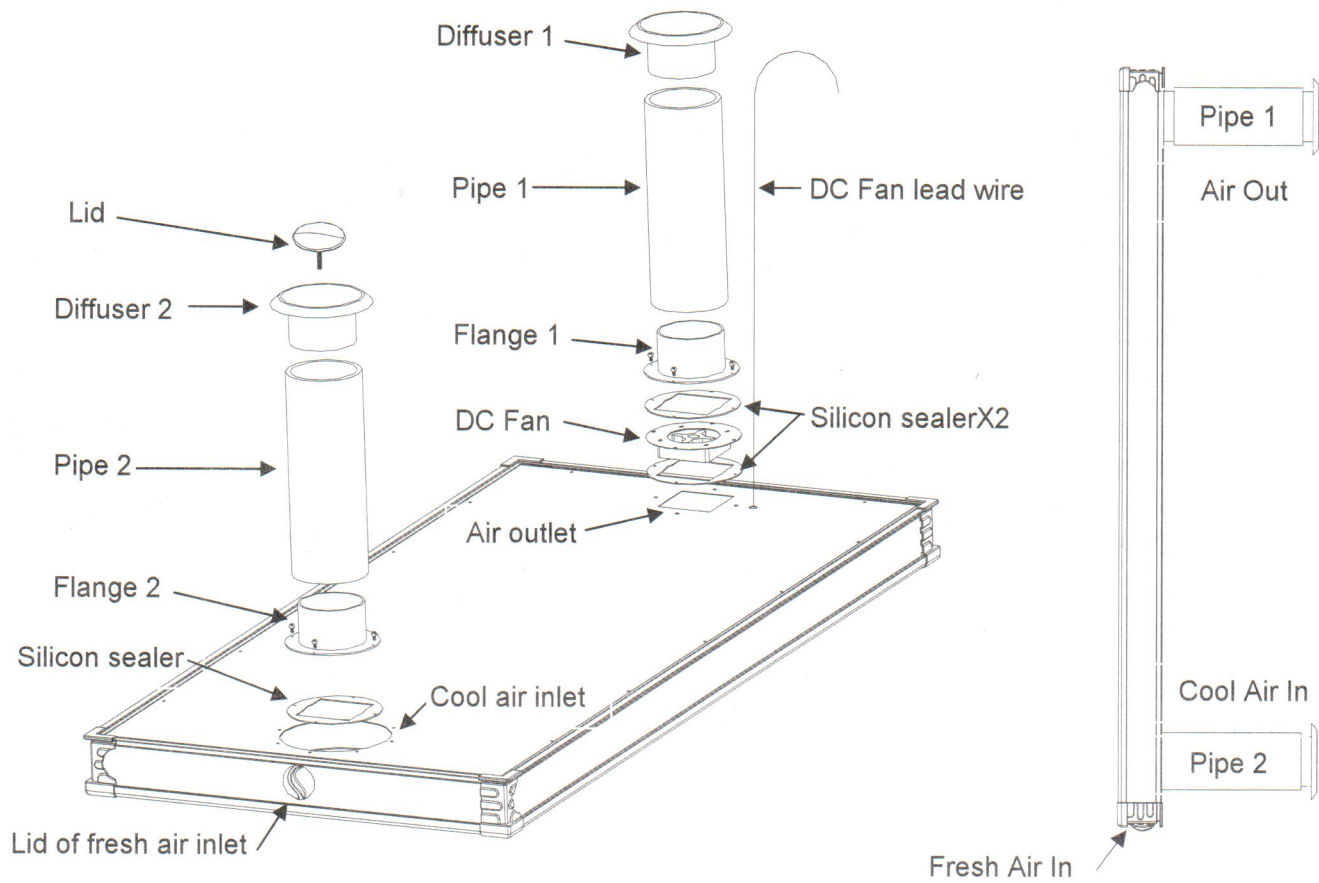

Secure thermostat onto the inside wall near the diffuser
Connect lead wire from solar heater to thermostat

Connect either one wire to terminal 2, and
connect other wire to terminal 3

Disposal Information



This marking indicates that this product should not be disposed with other household wastes throughout the EU. To prevent possible harm to the environment or human health from uncontrolled waste disposal, recycle it responsibly to promote the sustainable reuse of material resources. To return your used device, please use the return and collection systems or contact the retailer where the product was purchased. They can take this product for environmental safe recycling.

Do not dispose of electrical appliances as unsorted municipal waste, use separate collection facilities. Contact your local government for information regarding the collection systems available. If electrical appliances are disposed of in landfills or dumps, hazardous substances can leak into the groundwater and get into the food chain, damaging your health and well-being.

Room Temperature Controller

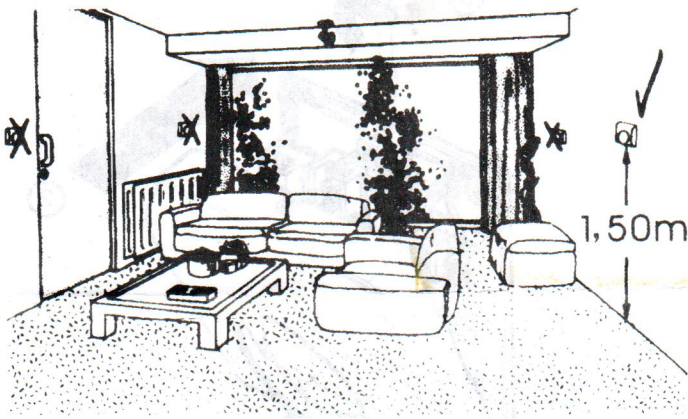

1

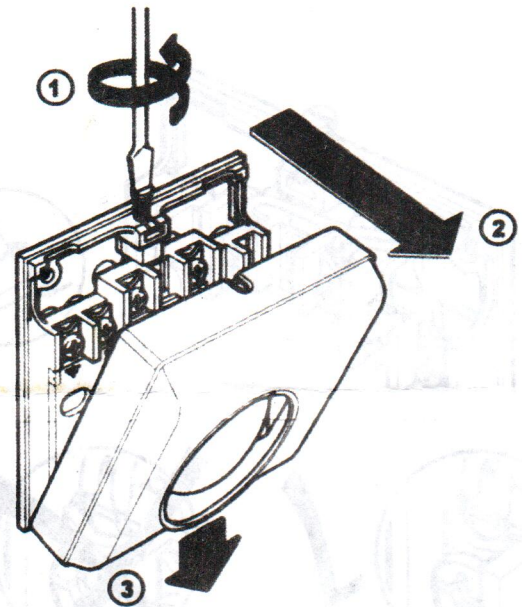

2 (a)

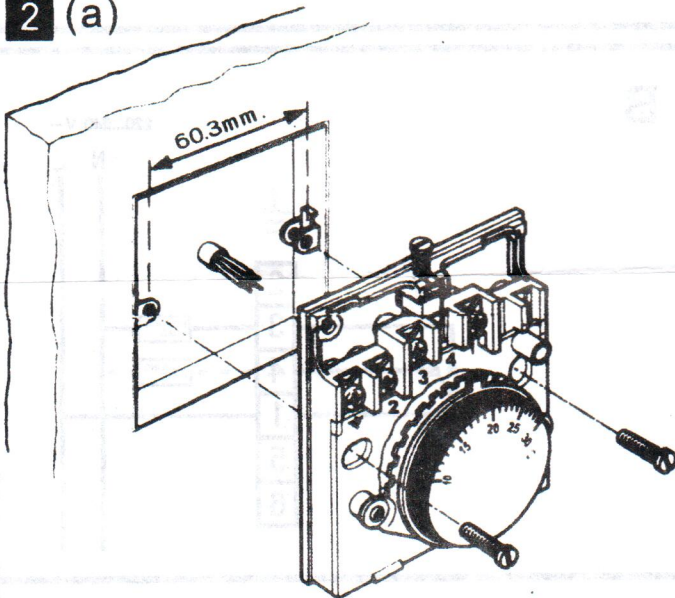

2 (b)

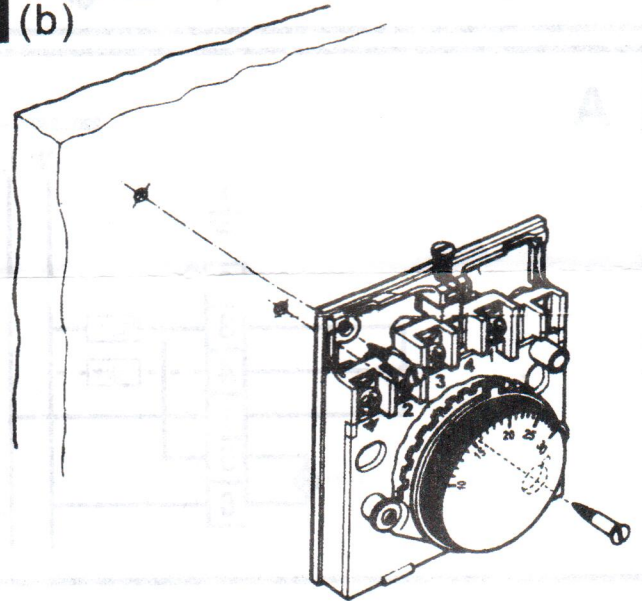

3 (a)

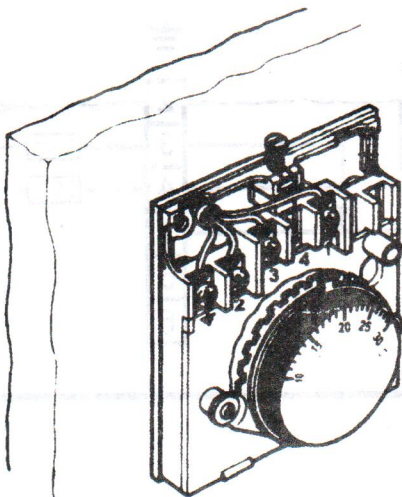

3 (b)

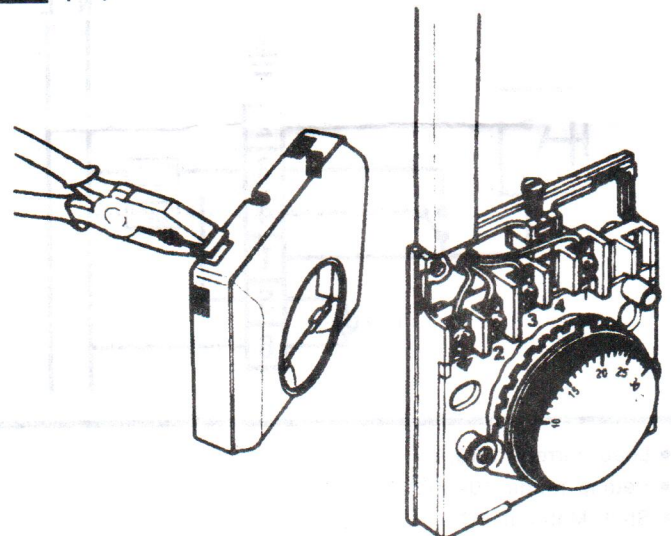

4

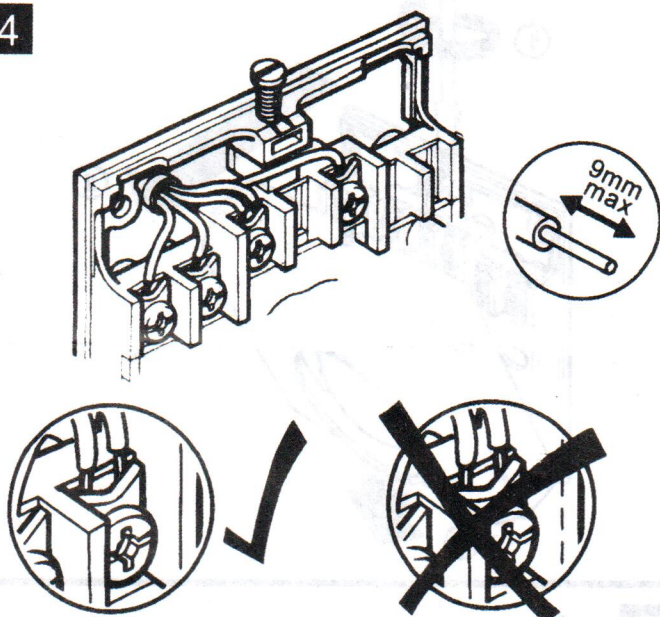

5

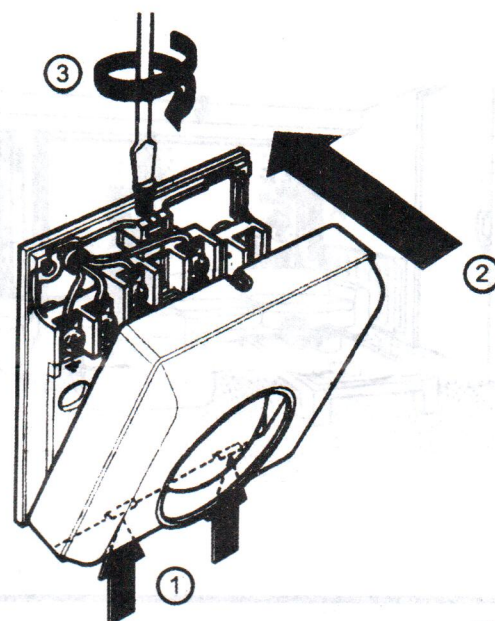

A

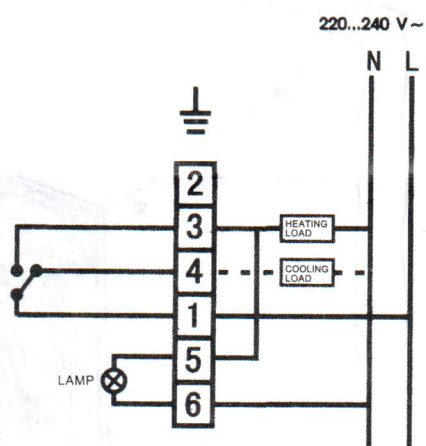

B

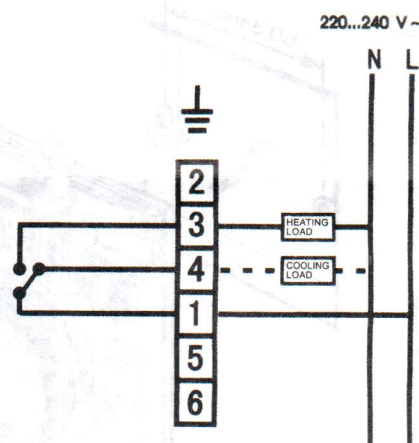

C

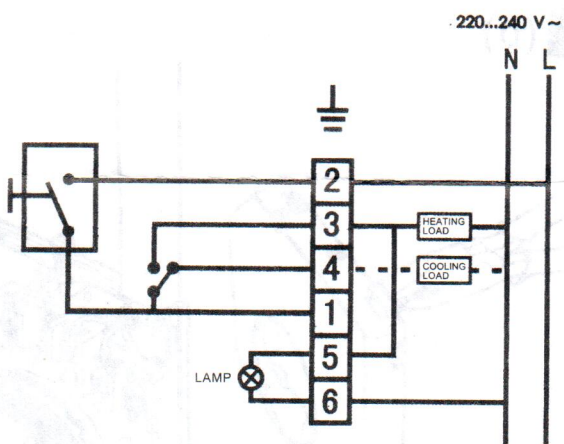

D

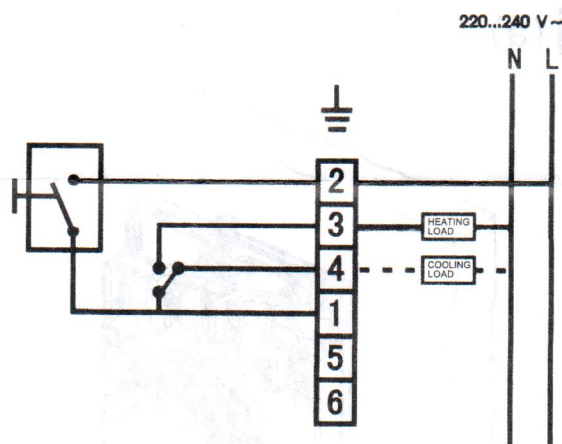

- Load current: 10(3)A
- Setting range: 10–30°C
- Shell Material: PC
- Dimensions: 86x86x40